

INSTALL PARAMETERS

DAVIT FOOT AND WALL MOUNTING BRACKETS

PC. 915401, 915402



Floor Mounting Bracket
915401



Wall Mounting Bracket
915402

When used in conjunction with a 915400 Davit: EN795:2012 Type A

This equipment is intended for use by people who have received proper training and are competent.

HOW TO INSTALL -

Installation requirements of Davit Floor & Wall Mount Base:

Structure : The receiving structure must be able to withstand stresses equivalent to 22.1 MPa or 22.1N/mm². The fasteners/structural anchors must be strong enough to handle this strain. Refer Fastener manufactures UIM for stainless steel/High tensile M16 fasteners.

Floor Mount Base 915401 are designed for mounting to concrete or steel structures.

Installation :

- Thickness of concrete block should be minimum 230mm
- All receiving Structures should be verified by a qualified structural Engineer.
- Base Installation must be approved to local regulations by a qualified engineer.
- Refer to Fastener Manufacturer to ensure the correct fasteners are used.
- If the Base material does not meet the minimum requires to install, then reinforcement is required. Refer to a qualified engineer.
- Drill holes should have a minimum clearance of 280mm from all available edges
- If unsure, refer to a qualified engineer to recommend the location to mount the Floor mount base to the structure.
- Drill 4 holes using the base as a guide
- Install the recommended M16 fasteners and mount the base then tighten the bolts.
- Can also be installed on cantilever of concrete beam by sand-witching two plates on concrete structure
- Suitable M16 fasteners should be used for fixing the brackets to the structure.

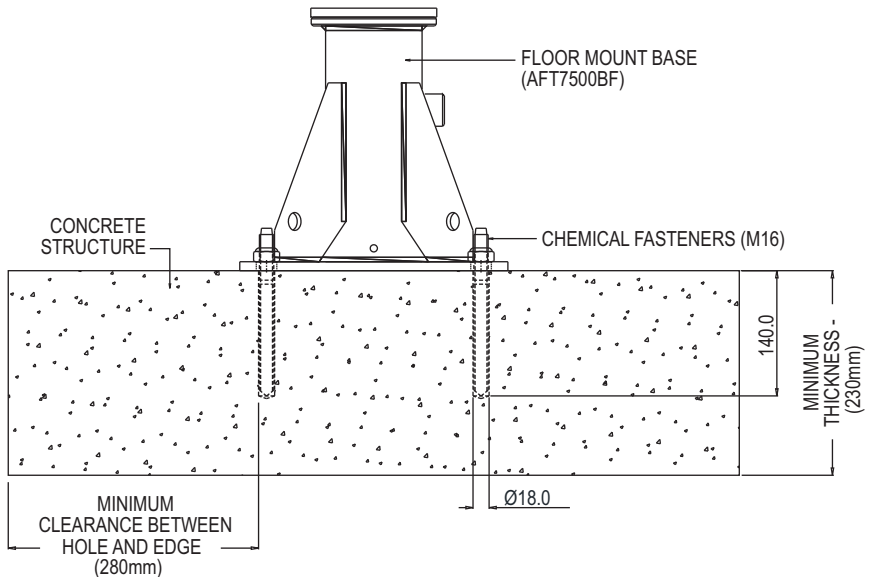
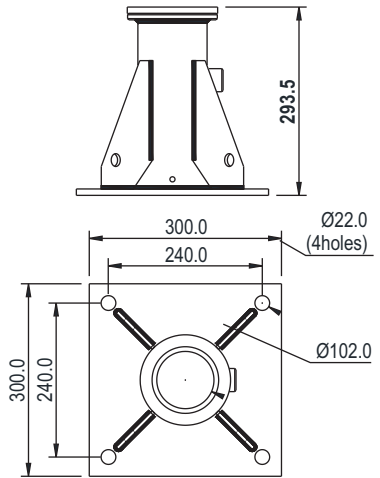

WARNING : Failure to follow User Instructions and Installation instructions may lead to severe injury and/or death.

Wall Mount Base 915402 are designed for mounting to concrete or steel structures.

Structure : The receiving structure must be able to withstand stresses equivalent to 22.1 MPa or 22.1N/mm². The fasteners/structural anchors must be strong enough to handle this strain. Refer Fastener manufactures UIM for stainless steel/High tensile M16 fasteners.

Installation :

- Thickness of concrete block should be minimum 230mm
- All receiving Structures should be verified by a qualified structural Engineer.
- Base Installation must be approved to local regulations by a qualified engineer.
- Refer to Fastener Manufacturer to ensure the correct fasteners are used.
- If the Base material does not meet the minimum requires to install, then reinforcement is required. Refer to a qualified engineer.
- Drill holes should have a minimum clearance of 280mm from all available edges
- If unsure, refer to a qualified engineer to recommend the location to mount the Floor mount base to the structure.
- Drill 4 holes using the base as a guide
- Install the recommended M16 fasteners and mount the base then tighten the bolts.
- Can also be installed on cantilever of concrete beam by sand-witching two plates on concrete structure
- Suitable M16 fasteners should be used for fixing the brackets to the structure.

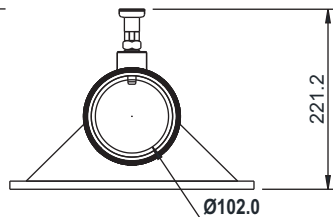
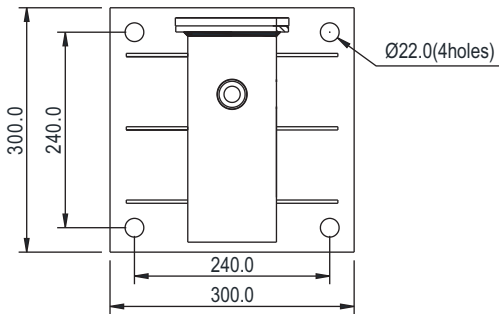
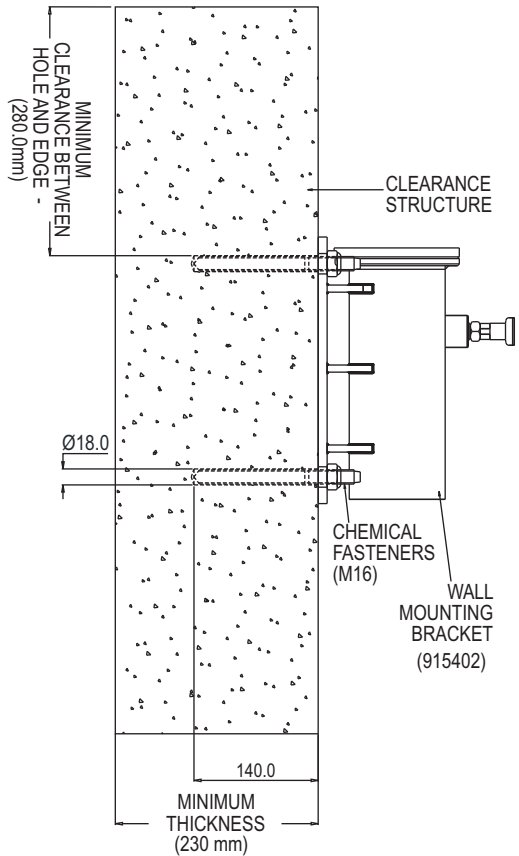

WARNING : Failure to follow User Instructions and Installation instructions may lead to severe injury and/or death.

LIFESPAN: The estimated product Lifespan is 10 years from the date of manufacture. The following factors can reduce the Lifespan of the product: intense use, contact with chemical substances, specially aggressive environments, extreme temperature exposure, UV exposure, abrasions, cuts, violent impacts, bad use or maintenance.

DISCLAIMER: Prior to use, the end user must read and understand the manufacturer's instructions supplied with this product at the time of shipment and seek training from their employer's trained personnel on the proper usage of the product. Manufacturer is not liable or responsible for any loss, damage or injury caused or incurred by any person on grounds of improper usage or installation of this product.

EQUIPMENT RECORD				
Product				
Model & type/Identification		Trade Name	Identification number	
Manufacturer		Address	Tel, email into use	
Year of manufacture		Purchase Date	Date first put into use	
Other relevant information (eg. document number)				
PERIODIC EXAMINATION AND REPAIR HISTORY				
Date	Reason for entry (periodic examination or repair)	Defects noted, repairs carried out and other relevant information	Name and signature of competent person	Periodic examination next due date



AUSTLIFT®

WHOLESALEERS OF LIFTING, RIGGING, LOAD RESTRAINT
& HEIGHT SAFETY PRODUCTS

AUSTRALIAN LIFTING CENTRE

1300 100 120

www.austlift.com.au

QLD Office



7 Durbell Street
Acacia Ridge, QLD 4110



Ph : 07 3272 0777

WA Office



42 Mulgool Road
Malaga, WA 6090



Ph : 08 9248 6674

Head Office (NSW)



43 Frank Street
Wetherill Park, NSW 2164



Ph : 02 9757 2277

VIC Office



475 Dohertys Road
Truganina, VIC 3029



Ph : 03 9314 5525